

KirariMUSE (Electrical Listening Lod)

Quick Start Guide

Thank you very much for purchasing this product.
Before using the product, please read this document to ensure proper use.

About Quick Start Guide
Composition of the "Quick Start Guide" for this product

Contents

1. Confirmation of contents and part name	p2
2. Smartphone charging	p3
3. Environment setting	p4 - p13
4. Initial setup of PC application	p14 - p16
5. Data measurement and storage method	p17 - p20

4 Password

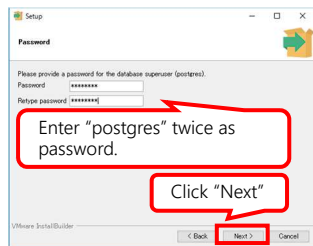

5 Port

Specify the port number to communicate with PostgreSQL.
Normally, the default of 5432 is fine.

6 Advanced Options

Click "Next"

7 Ready to Install

Click "Next"

8 Installing

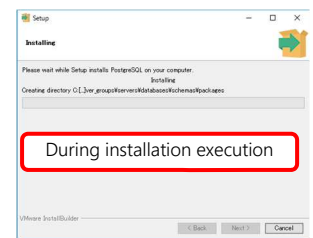

9 Completing the PostgreSQL Setup Wizard

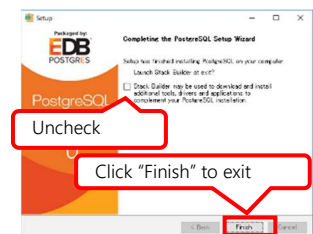

1 Confirmation of contents and part name

➤ If any item is missing or not applicable, please contact the source of purchase.

- Main unit

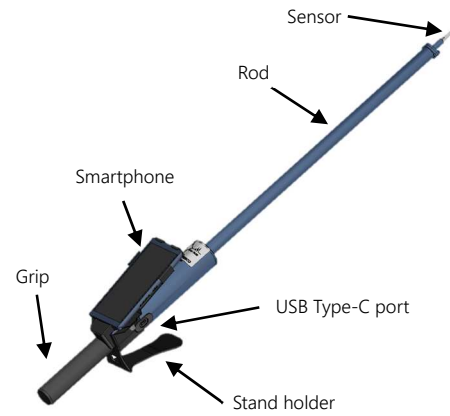

- AC adapter
- Power conversion plug
- Quick Start Guide (this document)
- Save following files in the smartphone
 - PC Application
 - Reference Manual

2 Smartphone charging

2 Smartphone charging

- (1) Connect the smartphone to the AC adapter.
➤ Use the AC adapter with the included charger. If the shape of the power plug is different, use power conversion plug.

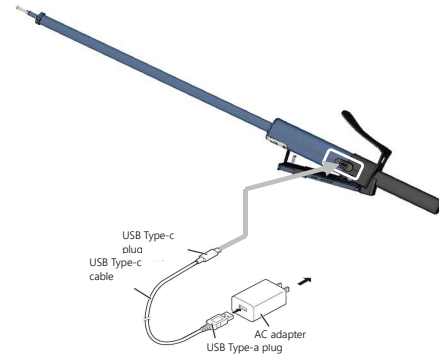

- (2) When charging is complete, return the cable connection to its original position and turn on the smartphone using the power button below.

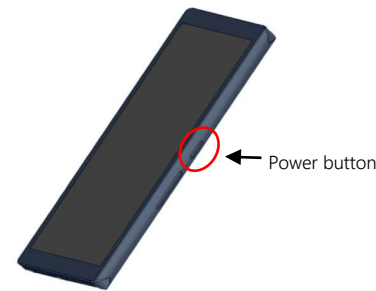

3 Environmental setting

- (6) Execute the batch file "5-python_install.bat" in the "installation_media" folder by double-clicking it.

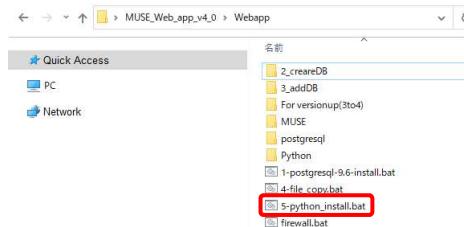

The installation procedure is now complete.

3.3 Start the PC application

Restart the PC

After a few moments, a window will rise and the server is start up when it appears as shown in the figure.

- It may take some time to start up. Please allow some time for completion

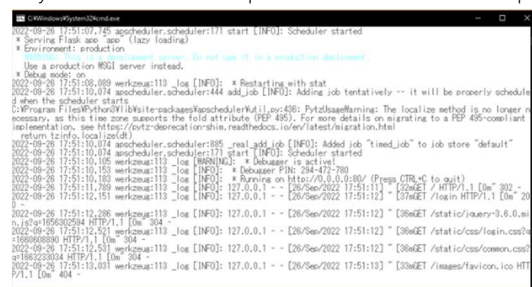

- Due to security policy, shortcuts cannot be created in the startup folder, and the server may not start when the PC starts. In that case, double-click "runMUSE.bat" in the "C:\MUSE\app" folder.

3 Environmental setting

3.1 Preparation for PC application

- The colors of images in this book may differ from the actual colors after printing.

Install the PC application by following procedure.

Transfer installer file from smartphone.

Connect your smartphone to your PC.

The function selection for USB connection will appear on the smartphone screen. Select "File Transfer".

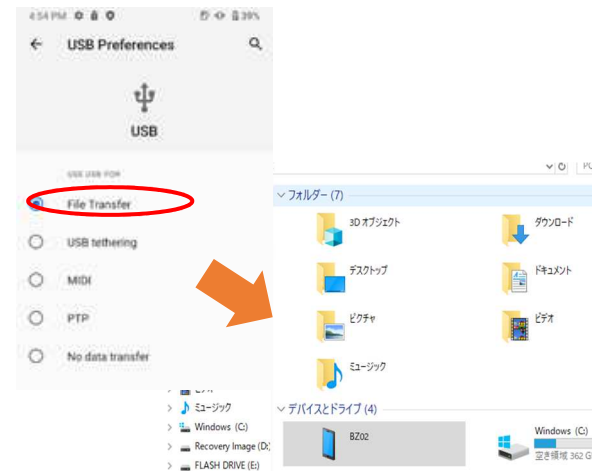

Once the PC terminal recognizes the smartphone (BZ02 in the figure), copy the installer file "installation_media" contained inside and paste it to the desktop of your PC or other working location.
After copying is complete, unzip the installer file.

3.2 PC Application Installation Procedure

- When the following screen appears, check the boxes for both private and public networks and click "Allow access".

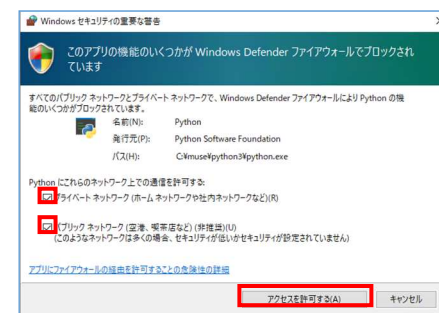

Start your browser and type "http://localhost/" in the address bar.

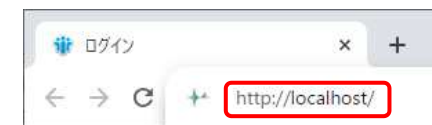

When the login screen appears, enter "Password: muse" and click the "Log in" button to log in.



3.2 PC Application Installation Procedure

➤ This procedure is for a new installation.

- If you are upgrading the software, please refer to the reference manual.
- Login as administrator for installation.
- If a User Account Control confirmation appears during installation, click Yes to continue.

- (1) Double-click on the "1-postgresql-9.6-install.bat" in "Webapp" folder to execute.

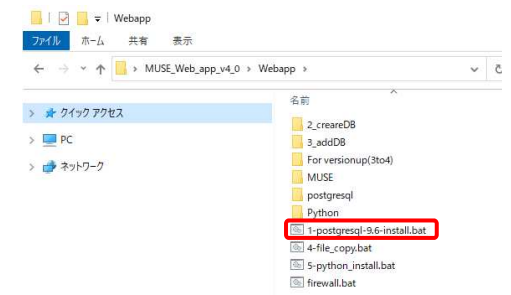

- (2) Follow the diagram to perform the installation

1 setup

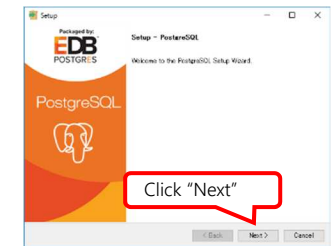

2 Installation Directory

Click "Next".

3 Data Directory

Click "Next".

3.4 Connecting with Android Apps

Connect your smartphone to your PC using either procedure A or B.

【A】 Connect from the same LAN.

As shown in the figure, have the smartphone and PC access the same LAN.

- Refer to the detailed manual for smartphone connections Refer to your router manual or PC manual for PC connections.

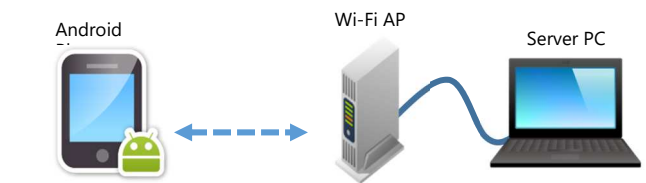

Launch the "KirariMUSE" Android application, tap the "... " button in the upper right corner of the screen, and enter the IP address of your PC from "Setting".

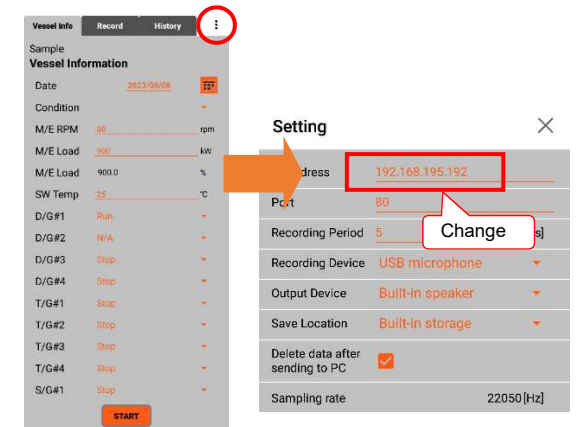

[B] Connection via USB tethering

When the smartphone and computer are connected with a USB cable (the smartphone side is a USB Type-C connector), a screen for selecting the USB connection function appears on the smartphone's screen. Select "USB Tethering" on the smartphone screen.

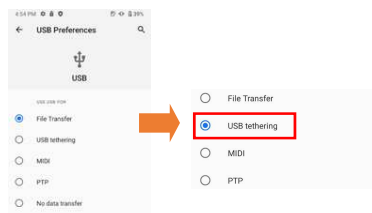

Execute command prompt. Enter "ipconfig /all" and press enter key.

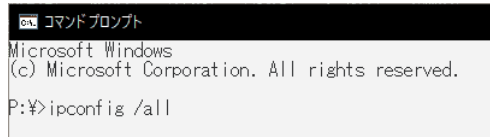

In the Ethernet Connection column, check the number of the "IPv4 address" set as shown in the following figure. (In the figure, 192.168.218.64 is the IP address)

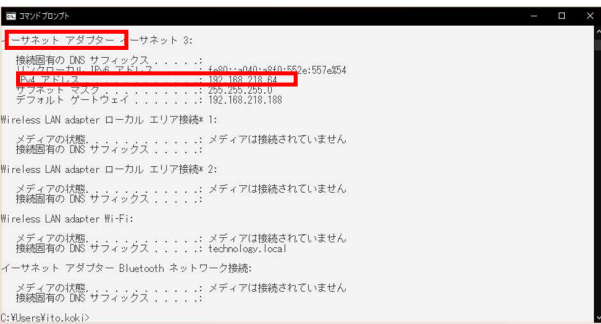

11

(4) Click on the pull-down menu on the screen and select "Point Registration". Select the registered category and device name from the pull-down menu as shown below.

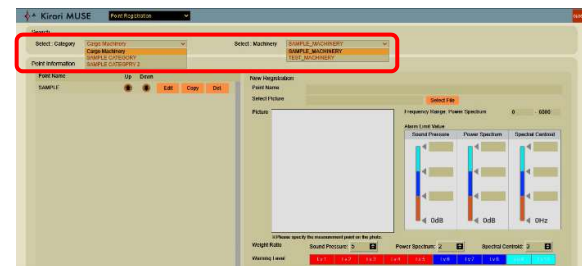

Please prepare a photo image of the measurement location in advance and register the measurement location as shown in the figure below.

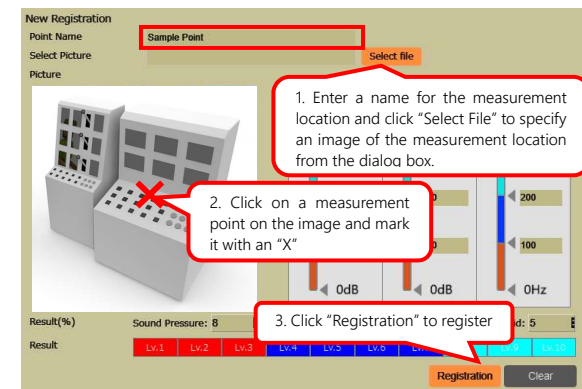

➤ This screen allows you to set the warning level for the measured data. Please refer to the detailed manual for a description of each item and how to set it.

16

Launch the "KirariMUSE" Android application, tap the "..." button in the upper right corner of the screen, and enter the IP address of your PC from "Setting".

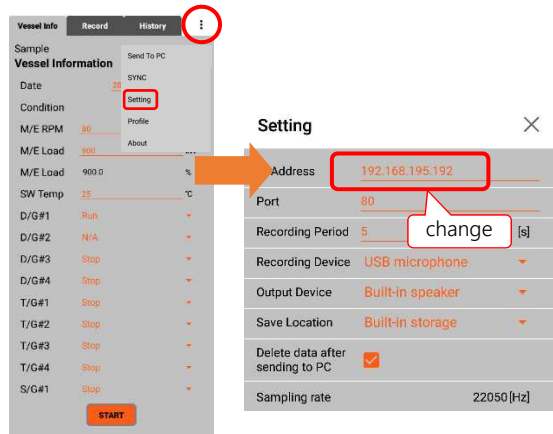

➤ With procedure [B], once you disconnect, the address is updated, so you need to go through step [B] every time you connect again; with procedure [A], once you set the address, you do not need to enter it again.

12

5 Data measurement and storage methods

5.1 Measurement of aural data

Start the Android application, check the contents of "Vessel Information", and if there are no problems, tap "START".

➤ Each item can be set on this screen. For details, please refer to the detailed manual.

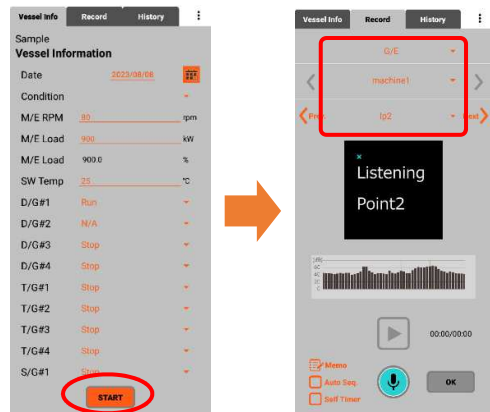

Set the sensor part at the tip of the Listening Rod in place on the instrument and start measurement.

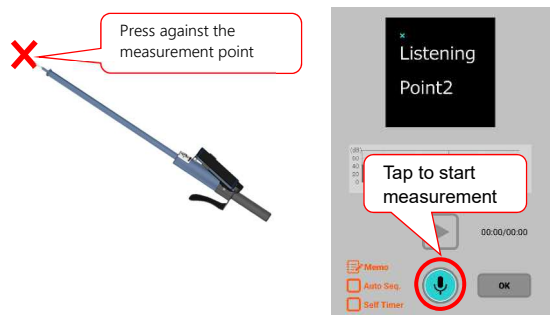

17

3.5 Synchronization with PC

Launch the "KirariMUSE" Android application, tap the "..." button in the upper right corner of the screen. Select "Setting" -> "SYNC" and tap the center button. Tap "OK" on the message below.

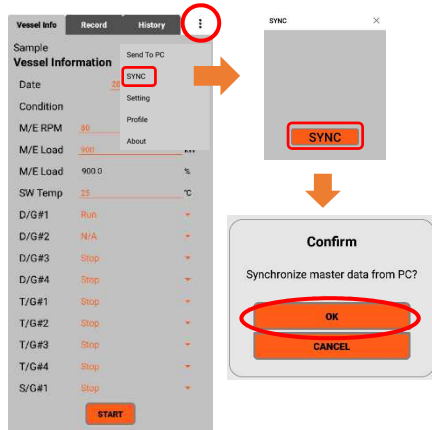

If the connection is successful, the following message is displayed.

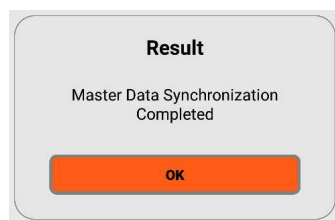

13

Measured data is automatically saved.

Saved Data can be viewed in the "History" tab.

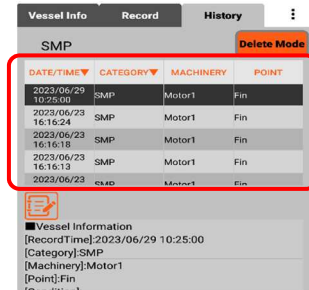

5.2 Transfer of measurement data

Tap "..." in the upper right corner of the screen and tap "Send to PC".

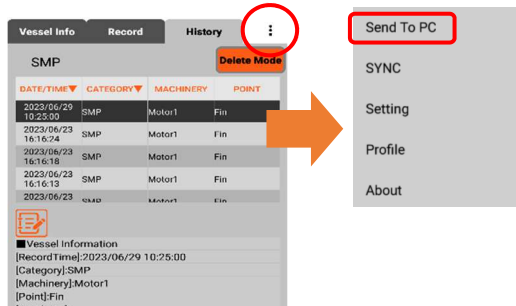

4 Initial setup of PC application

(1) After logging into the PC application, click the gear symbol (Settings) in the upper right corner of the screen. The following screen will appear. Register the vessel name and measurement items.

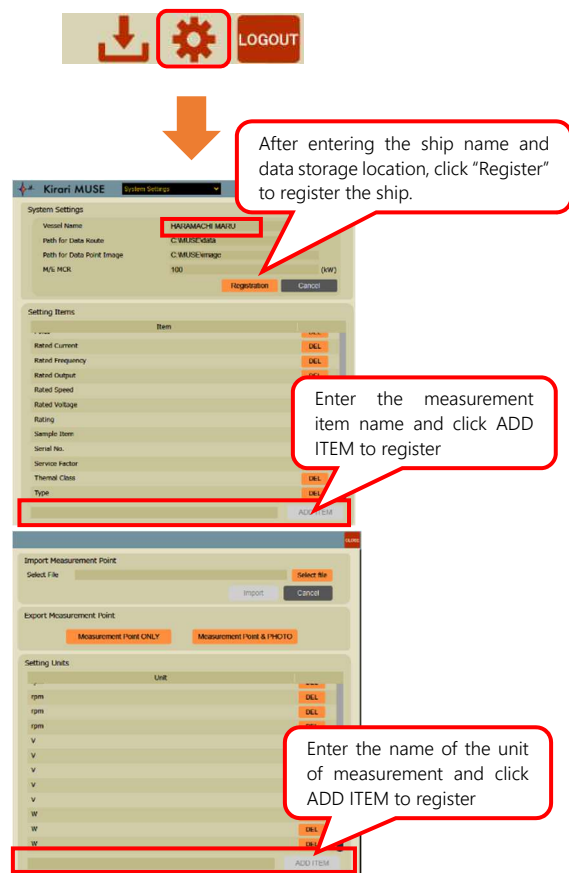

14

(2) Click on the pull-down menu labeled "System Setting" on the screen and select "Category Registration".

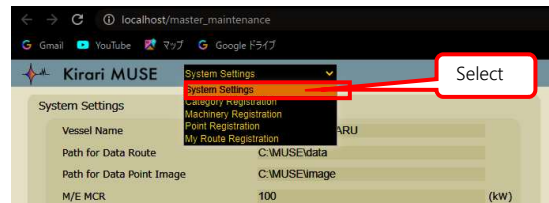

Register the category to be measured as shown in the following figure.

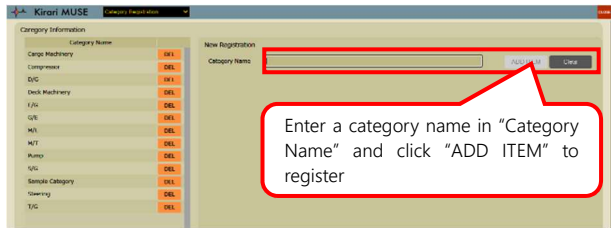

(3) Click the pull-down menu on the screen and select "Machinery Registration". Register the measuring machine as shown below.

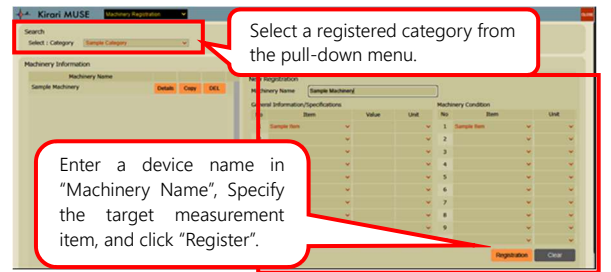

15

5.3 Confirm measurement data with PC application

After logging into the PC application, the measurement data can be viewed under "Latest Data" as shown below.

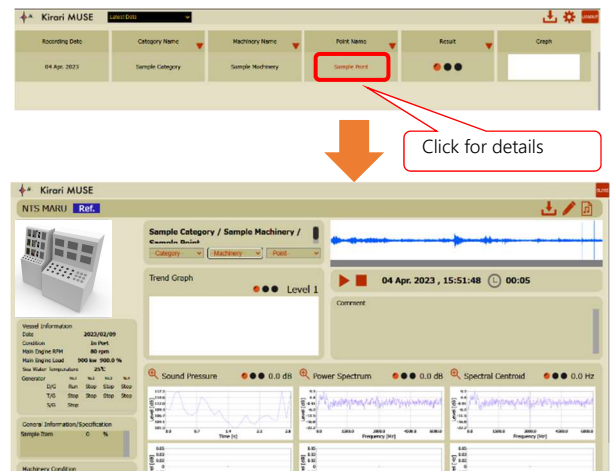

➤ Please refer to the detailed manual for explanations of each graph and numerical value and analysis methods.

19